

scale -1"=4"

Wood Queen Cage Holder

Drawn by Gary S. Reuter
University of Minnesota
Dept. of Entomology
12-07-01

Designed to fit into a standard frame and swing out for access.
5/16" thick stock except as indicated

Material List

#2 pine

- 2 - 3/4 x 13/16 x 3
- 2 - 5/16 x 2 x 16-7/8
- 1 - 5/16 x 1-7/16 x 16-7/8

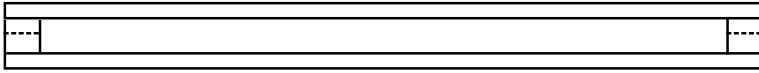

holds 3 hole cages

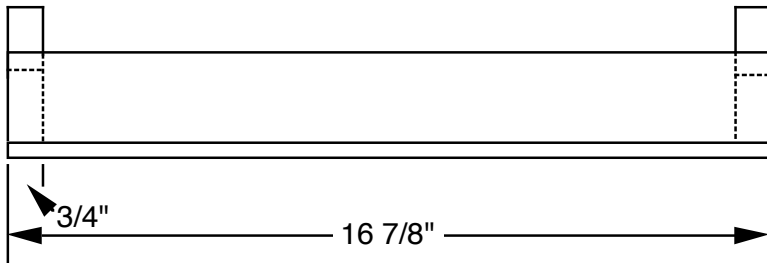

Hole on end to fit 4p nail tight.
This lines up with a hole in end of
frame to fit loose so when nail is put
in the holder swings out. (no scale)

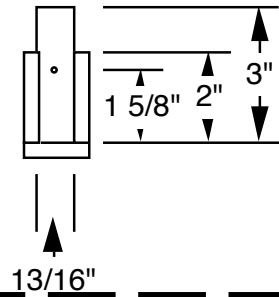
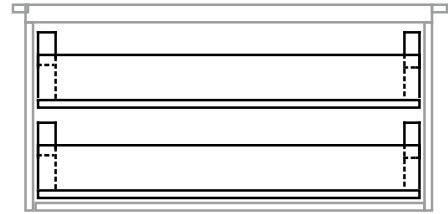

holds "California" cages

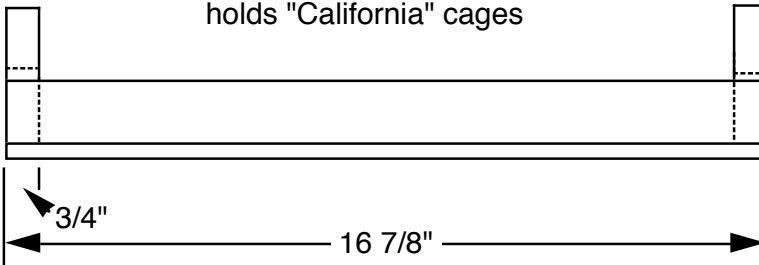

Material List

#2 pine

- 2 - 3/4 x 15/16 x 2-3/8
- 2 - 5/16 x 1-1/4 x 16-7/8
- 1 - 5/16 x 1-9/16 x 16-7/8

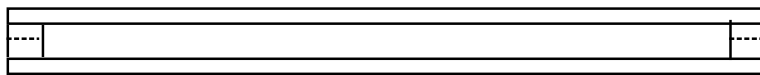
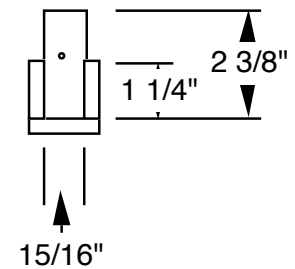

combination

holds 3 hole cages facing one way and
"California" cages facing the other way

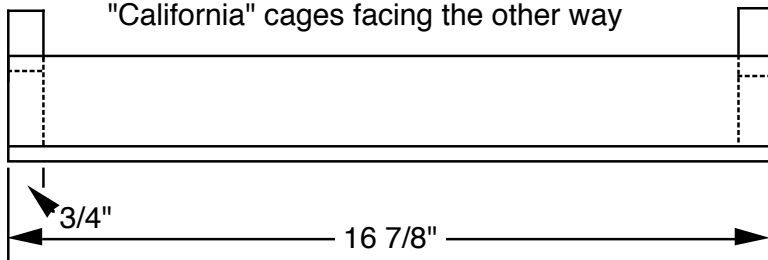

Material List

#2 pine

- 2 - 3/4 x 15/16 x 3
- 2 - 5/16 x 1-1/4 x 16-7/8
- 1 - 5/16 x 2 x 16-7/8
- 1 - 5/16 x 1-9/16 x 16-7/8

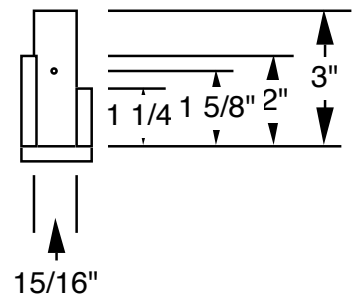

scale -1"=4"

Wood Queen Cage Holder

Drawn by Gary S. Reuter
University of Minnesota
Dept. of Entomology
12-07-01

Designed to hang in a standard box in place of a frame.

5/16" thick stock except as indicated

Material List

#2 pine

- 2 - 3/4 x 13/16 x 2-7/8
- 2 - 5/16 x 2 x 17-3/4
- 1 - 5/16 x 1-7/16 x 17-3/4
- 2 - 1/2 x 13/16 x 1-7/8
- 4 - 5/16 x 1-1/4 x 1-3/8

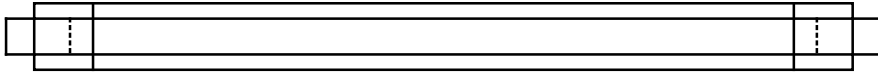

holds 3 hole cages

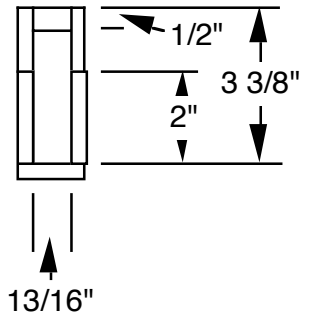
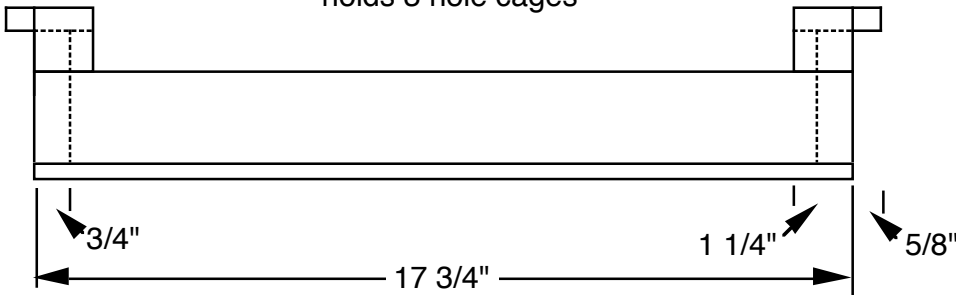

Material List

#2 pine

- 2 - 3/4 x 15/16 x 2
- 2 - 5/16 x 1-1/4 x 17-3/4
- 1 - 5/16 x 1-9/16 x 7-3/4
- 2 - 1/2 x 5/16 x 1-7/8
- 4 - 5/16 x 1-1/4 x 1-1/4

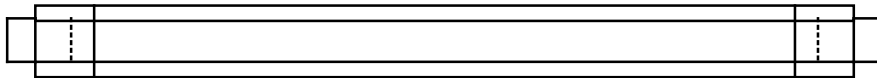

holds "California" cages

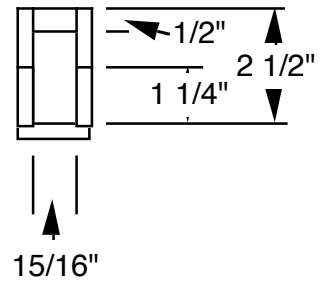
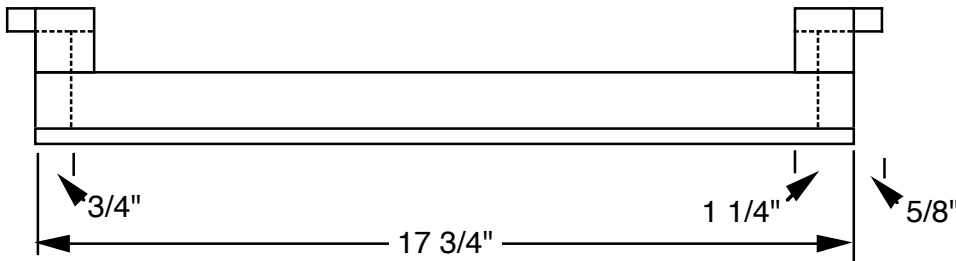

Material List

#2 pine

- 2 - 3/4 x 15/16 x 2-7/8
- 1 - 5/16 x 2 x 17-3/4
- 1 - 5/16 x 1-1/4 x 17-3/4
- 1 - 5/16 x 1-9/16 x 7-3/4
- 2 - 1/2 x 5/16 x 1-7/8
- 4 - 5/16 x 1-1/4 x 1-3/8

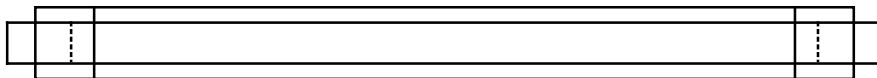

combination

holds 3 hole cages facing one way and "California" cages facing the other way

